

Open Market

9/02/2025

Selected Furniture Catalogue

CH3348-OSJ | MBA



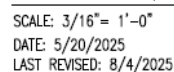

VENDOR/CONTRACTOR/GSA ARE RESPONSIBLE FOR THE ACCURACY OF RESPECTIVE FIELD DIMENSIONS DURING QUOTING AND PRIOR TO INSTALLATION.

● - GROMMET LOCATIONS | REFER TO DRAWING AND RFQ TABLE
 ■ = ELECTRICAL/DATA PERFORATION AT WALL PANEL
 INCLUDE WIRE MANAGEMENT TO CONCEAL WIRING UNDER DESKS
 FOR FURNITURE DIMENSIONS REFER TO RFQ FURNITURE TABLE

SENSITIVE BUT UNCLASSIFIED (SBU)
PROPERTY OF THE UNITED STATES GOVERNMENT
FOR OFFICIAL USE ONLY
Do not remove this notice
Properly destroy or return documents when no longer needed



DATE	TYPE	PERFORMED BY
8/04/2025	REV2	IRNALI HERNANDEZ ARCHITECT
6/10/2025	REV1	IRNALI HERNANDEZ ARCHITECT
5/20/2025	PROP	IRNALI HERNANDEZ ARCHITECT
A/E CON. NO.		
A/E TASK NO.		
CONC. CONTR.		
CONC. WORK		
PRIME A/E		
SUB A/E		
CONSTR. CON.		
KEY PLAN		
NAME	JOSE V. TOLEDO FB & U.S. CTSE	
STREET	BUILDING 300 CALLE DEL RECENTO SUR	
CITY/ST./ZIP	SAN JUAN	PR 00900
BUILDING NO.	PR0003	FACILITY CODE:
OTHER		
BUILDING NAME	USDC TOLEDO COURTHOUSE - CH-42	
PROJECT TITLE	CH348 TOLEDO - FURNITURE SELECTION	
PROJECT DESCRIPTION	CH348 TOLEDO - FURNITURE SELECTION FOR JUDGE CHAMBER	
PROJECT NO.		
USDC PM	IRNALI HERNANDEZ, ARCHITECT / INT DESIGNED	
SUB. DATE		
ORG. SURVEY DATE		
DRAWING TITLE	OSU CH348 MEA CHAMBER FURNITURE	
FILE NAME	P1	
FLOOR NO.		
DRAWN BY	PH	QUERY DATE: 9/2/2025
CHECKED BY	FD & GWM	SHEET SIZE: 11 X 17
DRAWING NO.	PROPOSED - FURNITURE PLAN	
	DISCIPLINE SHEET TYPE SEQUENCE	



Selected Furniture Floor Plan



F500 by Artifort
product information

Offered through a partnership with Artifort in Schijndel, The Netherlands, the F500 series distinguishes itself as a classic armchair with a comfortable shape and striking upholstery. Designed by Geoffrey Harcourt RDI in 1967, this classic piece blossomed from the idea that Harcourt's girlfriend liked to curl up in a lounge chair in a cross-legged position. This resulted in the F500: a chair that has all the comfort of an easy chair, and wide enough to meet this unusual seating area.

Three upholstery styles makes the chair highly configurable and unique. A fixed upholstery has clean styling for corporate interiors, a welted version add aspects of home while the tufted button version is an iconic piece that makes a statement.

Lounge Chair | Upholstery:
LUUM / Multipurpose | Simplicity
Color: Lavender



Dimensions

F510 Series

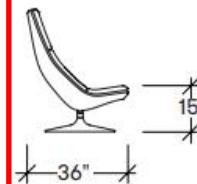
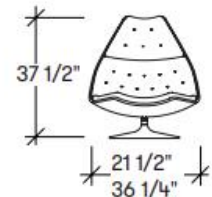
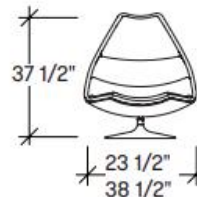
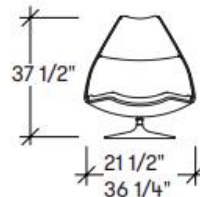
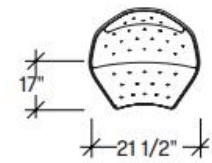
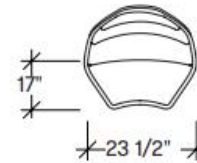
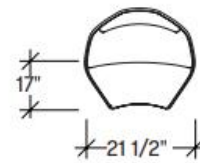

Lounge Chair, Disc Base,
Fixed upholstery
F510

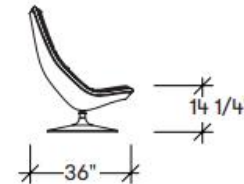

Lounge Chair, Disc Base,
Fixed upholstery
with Welt
F585

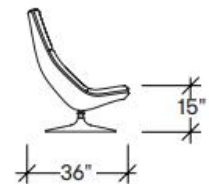

Lounge Chair, Disc Base,
Tufted upholstery
F588

Lounge Chair: Metal DISC base

Teknion | Foundation Paint
Color: Sand | 27/3

L

studio | <

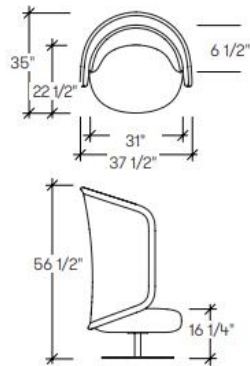
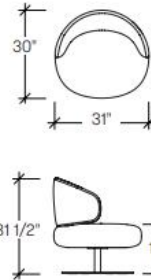
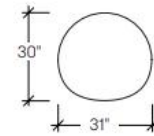

Dimensions

Libelle Lounge, Lounge
with Privacy Screen
(TKBA3)Libelle Lounge, Lounge
(TKBA2)Libelle Lounge, Pouf
(TKBA1)libelle
Libelle

Lounge chairs Upholstery
LUUM / Multipurpose | Actuate
Color: Induction

Lounge chairs Metal base and table support:
Teknion | Foundation Paint
Color: Sand | 27/3

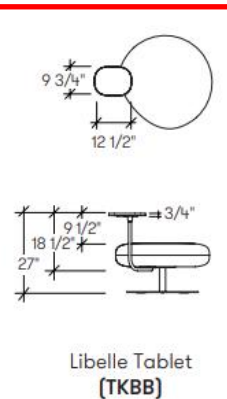
Libelle Tablet
(TKBB)

Writing tablet TOPS:
Teknion | Foundation Laminates
Color: Smoked Oak | 7B

libelle lounge product information

Libelle, Dutch for "Dragonfly", is a functional, yet whimsical, collection of seating options, including: a pouf, a low back lounge chair, and an innovative lounge chair with privacy. Designer Khodi Feiz created Libelle to deliver a personal escape while accommodating small collaborative interactions. An optional tablet arm is a versatile addition that will enhance functionality and can be installed after it's placed to either the left or right side. The laidback but sophisticated style of Libelle is perfect for today's flexible work environment.

Collection

